



# HI-STANDARD PISTOLS



PARTS PRICE LIST — 22 CALIBER (MODELS\* M-100, M-101)

"Dura-Matic"

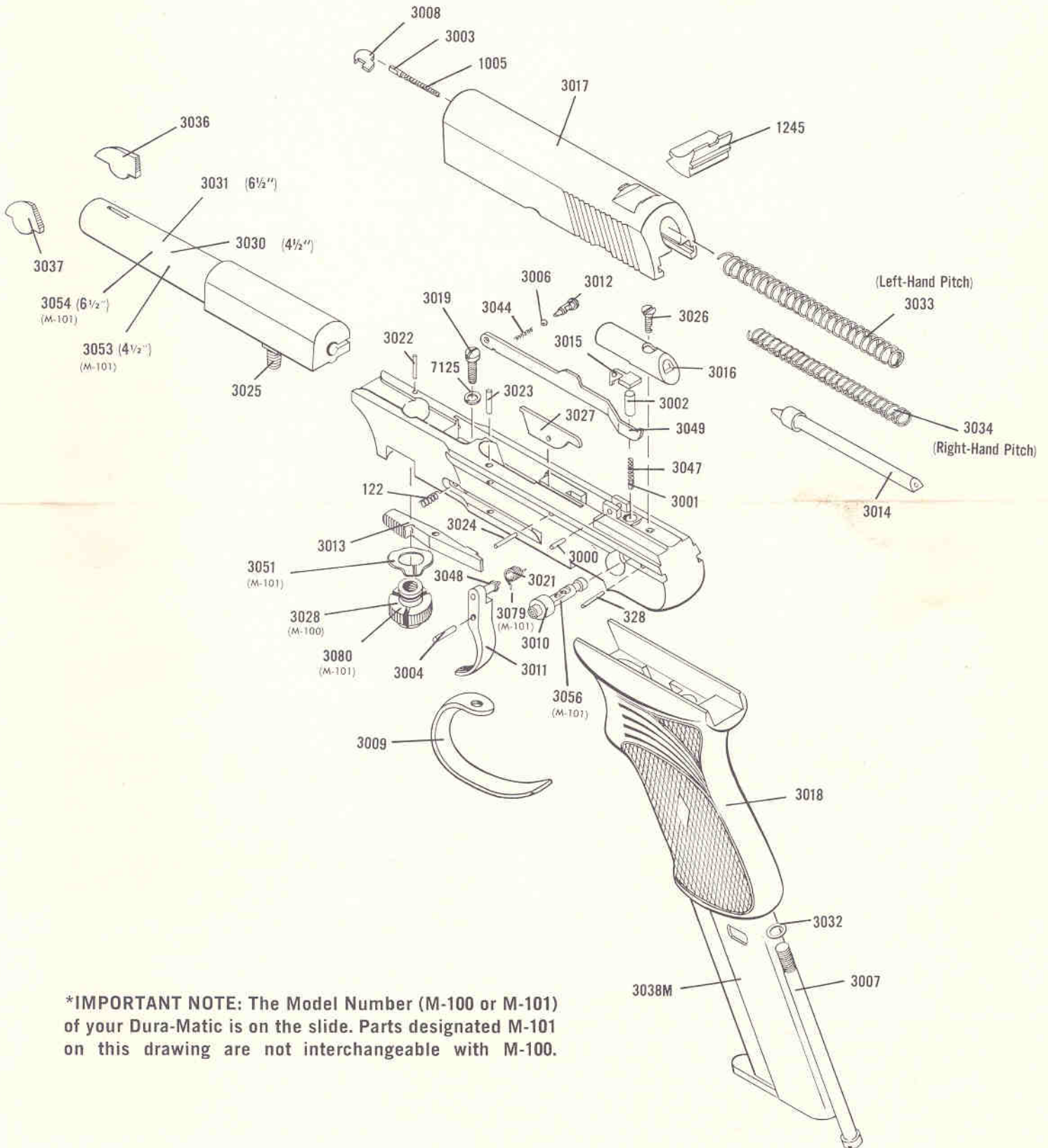

**\*IMPORTANT NOTE:** The Model Number (M-100 or M-101) of your Dura-Matic is on the slide. Parts designated M-101 on this drawing are not interchangeable with M-100.





PART NO.	PART NAME	MODEL	PRICE EACH	PART NO.	PART NAME	MODEL	PRICE EACH
3000	Sear Pin	M-100, M-101	.30	3034	Striker Spring	M-100, M-101	.30
3002	Sear Plunger	M-100, M-101	.30	3011	Trigger	M-100, M-101	2.00
3047	Sear Spring	M-100, M-101	.30	3009	Trigger Guard	M-100, M-101	.50
3037	Sight, Front, Short Barrel	M-100, M-101	1.25	3050	Trigger Guard Screw	M-100, M-101	.30
3036	Sight, Front, Long Barrel	M-100, M-101	1.25	7125	Trigger Guard Screw Lock Washer	M-100, M-101	.30
1245	Sight, Rear, Fixed (No Adjustable Rear Sight Available for this Model)	M-100, M-101	1.50	3004	Trigger Pin	M-100, M-101	.30
3017	*Slide (only)	M-100, M-101	13.50	3048	Trigger Pull Pin	M-100	.30
3033	Slide Spring	M-100, M-101	.30	3021	Trigger Spring	M-100	.30
3014	Striker Pin (See "Note" Below)	M-100, M-101	2.50	3079	Trigger Spring	M-101	.30
3016	*Striker Sleeve	M-100, M-101	1.75	3041	*Slide and Rear Sight Assembly (Includes Rear Sight, Extractor, etc.)	M-100, M-101	17.60
3026	Striker Sleeve Screw	M-100, M-101	.30				
3077	Striker Sleeve Screw Locking Pin	M-100, M-101	.30				

\*Slides and Striker Sleeves are not considered interchangeable and must be fitted at the factory.



## BEST FOR FUN and FIELD . . . HI-STANDARD FIREARMS . . .



**FLITE-KING**, 12 and 16 gauge, Pump Action Shotguns shoot all 2¾" shot shells, even rifled slugs. A wide variety to choose from — plain barrel, ventilated rib, adjustable choke, skeet and trap grades.



**SUPERMATIC**, 12 gauge, Autoloading Shotguns, ranging from low priced plain barrel to super grade skeet and trap models.



**FLITE-KING**, 20 and .410 gauge, Pump Action Shotguns. All 20 gauge guns shoot both 2¾" and 3" magnum shot shells. The .410 model feeds both 2½" and 3" shot shells.



**SPORT-KING CARBINE**, .22 autoloading rifle, shoots 12 Long Rifle, 14 Longs, 17 Hi-Speed Shorts interchangeably without manual adjustment. Tubular magazine. Western style American walnut stock with swivels and adjustable sling-strap. Brass butt plate and golden trigger guard, trigger and safety. Receiver dovetailed for scope. Beaded-post front sight. Rocky Mountain Partridge with stepped blade at rear. Convenient manual thumb safety, right hand side. Overall length 38½". Weight about 5½ pounds.



**FLITE-KING**, 12 gauge, Brush guns in 20" or 26" barrel lengths. Guns shoot all 2¾" shot shells and rifled slugs. Cylinder bore. Rifle sights, front sight ramped, copper color bead; rear sight, square notch, adjustable.



**HI-POWER DELUXE**, Bolt Action rifle, .30-06 Springfield or .270 Win. chambering. Capacity: four in magazine and one in chamber. Select American walnut checkered, Monte Carlo stock. Receiver drilled and tapped for all popular top mount scopes and receiver sights. Swivels included. Overall length 42¾". Weight about 7 pounds.

FREE FOLDER ON REQUEST . . .

### THE HIGH STANDARD MANUFACTURING CORPORATION

HAMDEN, CONNECTICUT

WE MAINTAIN A SERVICE DEPARTMENT WHICH WILL PROMPTLY GIVE YOU ADVICE AND SERVICE.



# INSTRUCTIONS FOR OPERATION AND CARE OF YOUR DURA-MATIC PISTOL

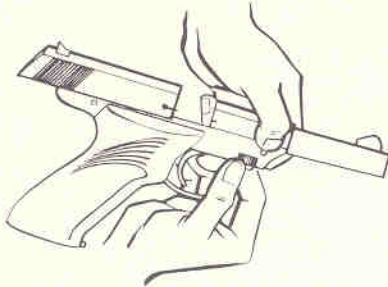

REMOVING BARREL

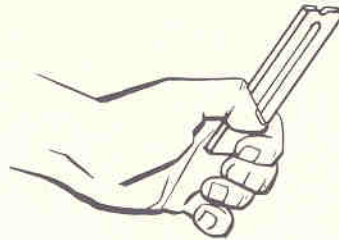

LOADING MAGAZINE

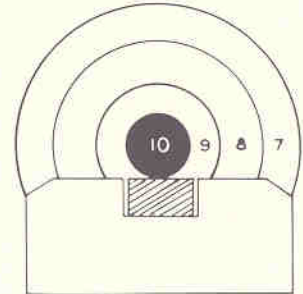

CORRECT SIGHT PICTURE

## DISASSEMBLY:

### NEVER ATTEMPT TO DISASSEMBLE BEFORE UNLOADING

1. Remove magazine by pressing magazine catch and allowing magazine to slide down and out of handle.
2. Pull slide to rear and lock open by moving safety to "on" position. (The safety acts also as a side lock, holding the slide in open position.)
3. **TO REMOVE BARREL ON MODEL-100:** Depress barrel lock plunger and unscrew barrel nut, allowing barrel to move up out of its seat in frame. **NOTE:** Slots in barrel nut permit use of coin to rigidly seat or unseat the nut.
4. **TO REMOVE BARREL ON MODEL-101:** Unscrew barrel nut, allowing barrel to move up out of its seat in frame. **NOTE:** Slots in barrel nut permit use of coin to rigidly seat or unseat the nut.  
**SAFETY:** Safety is in "ON" position when red paint on right side of safety button is not visible. (Safety locks Firing Pin Striker and Slide.)

## ASSEMBLY:

1. Replace slide spring in slide.
2. Replace striker and striker spring in slide. The striker spring rests inside the slide spring. Rotate striker so that flat on striker faces the slot in bottom of slide.
3. Replace slide on frame, lining up the grooves, and pull slide to rearmost position. Hold slide to rear and press safety "on," locking slide to rear.
4. Align barrel with the frame and tighten barrel nut.  
**NOTE:** Slots in barrel nut permit use of a coin to rigidly seat or unseat the nut.
5. Release slide by moving safety to "off" position. This will allow slide to move to battery position.
6. Replace magazine in grip and press until locked in place.

## LOADING AND FIRING:

1. Depress magazine catch, remove magazine and load it.
2. Replace magazine.
3. Pull slide to rear and release, allowing slide to move forward and strip a cartridge from magazine and feed it into the chamber. Gun is now ready to fire by pulling trigger. (This is a semi-automatic pistol and ten successive shots may be fired by simply pulling the trigger for each shot.)
4. Striker is also a visible indicator which shows unafailingly when pistol is cocked and ready to fire (see back end of slide).
5. If gun is not being fired, engage the safety. Always leave safety on until ready to fire. When engaged, the safety also locks the slide closed, making the arm safe to carry.

## SIGHT ADJUSTMENT:

Dura-Matic pistols are sighted in at approximately a 50-foot range. If lateral adjustment is desired because of individual preference in sighting or holding, tap the rear sight gently using a brass or plastic hammer. Move the rear sight in the direction you want the point of impact to move.

## DRY FIRING:

In dummy firing the pistol in practice, it is best to first insert a dummy shell or fired case into the chamber. This will prevent possible damage to the firing pin and the barrel.